

ZARN3585-L-TV

Axial/radial bearing

Schaeffler ID:
0016828220000

Needle roller/axial cylindrical roller bearings ZARN..-L, double direction, long shaft locating washer

Technical information

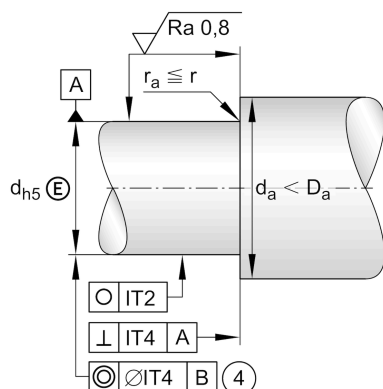

Main Dimensions & Performance Data

d	35 mm	Bore diameter
D	85 mm	Outside diameter
H	82 mm	Height
C _a	105,000 N	Basic dynamic load rating, axial
C _{0a}	265,000 N	Basic static load rating, axial
C _r	27,500 N	Basic dynamic load rating, radial
C _{0r}	53,000 N	Basic static load rating, radial
C _{ua}	22,900 N	Fatigue load limit, axial
C _{ur}	7,600 N	Fatigue load limit, radial
n _{G Oil}	4,000 1/min	Limiting speed for oil lubrication
n _{G Grease}	1,250 1/min	Limiting speed for grease lubrication
M _{RL}	2.3 Nm	Bearing friction torque
	1.871 kg	Weight

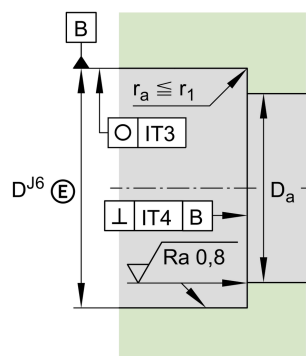
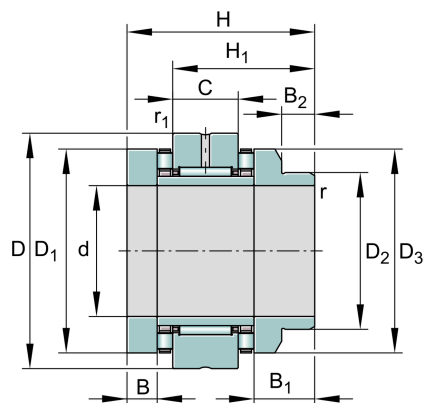

Dimensions

H ₁	59 mm	Height outer ring over wave washer
c _{axL}	3,500 N/μm	Rigidity axial
c _{kL}	1,300 Nm/mrad	Tilting stiffness
C	20 mm	Width, outer ring
M _m	10.4 kg * cm ²	Mass moment of inertia
	1 μm	Axial runout
D ₁	73 mm	Rip diameter shaft washer
D ₂	60 mm	Heeldiameter wave washer long
radial	ZMA35/70	Locknut 1
axial	AM35	Locknut 2
D ₃	73 mm	Outside diameter wave washer long
M _A	100 Nm	Tightening torque nut
B	14 mm	Width, inner ring
	27,480 N	Preload force axial
B ₁	30 mm	Width wave washer long
	60X75X8	Sealing ring
B ₂	13 mm	Width heel wave washer long
r _{min}	0.3 mm	Minimum chamfer dimension
r _{1 min}	0.6 mm	Minimum chamfer dimension

Mounting dimensions

D _{a max}	74 mm	Maximum diameter of housing shoulder
d _{a min}	58 mm	Minimum diameter shaft shoulder